

# GT-TC121X-HXXX-LX

### Operating Force

- A=160gf
- B=260gf
- C=100gf
- D=230gf

**Switch Height**  
H050=5.0mm

**Switch Lifetime (Force)**  
L1=100,000 Cycles

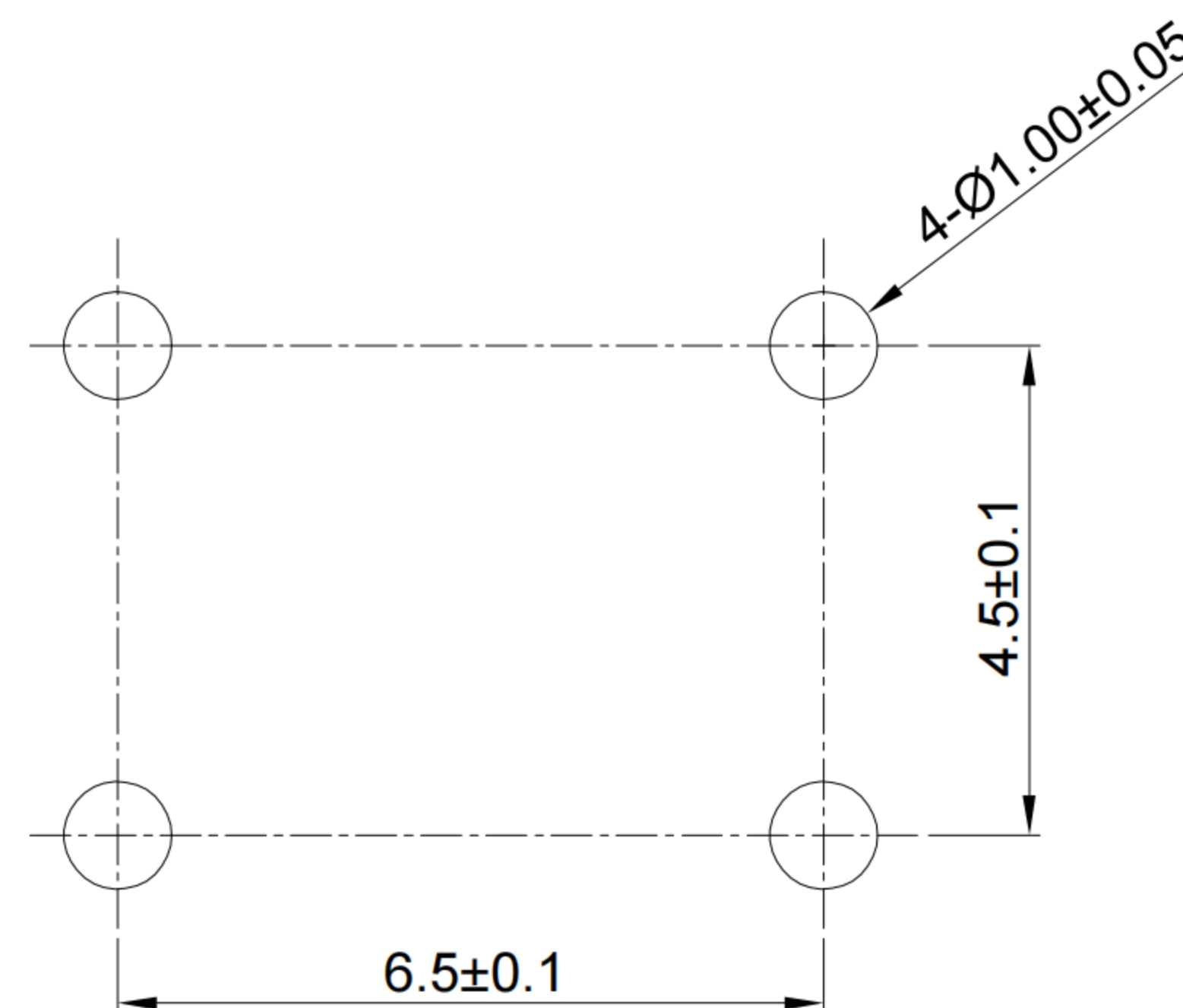
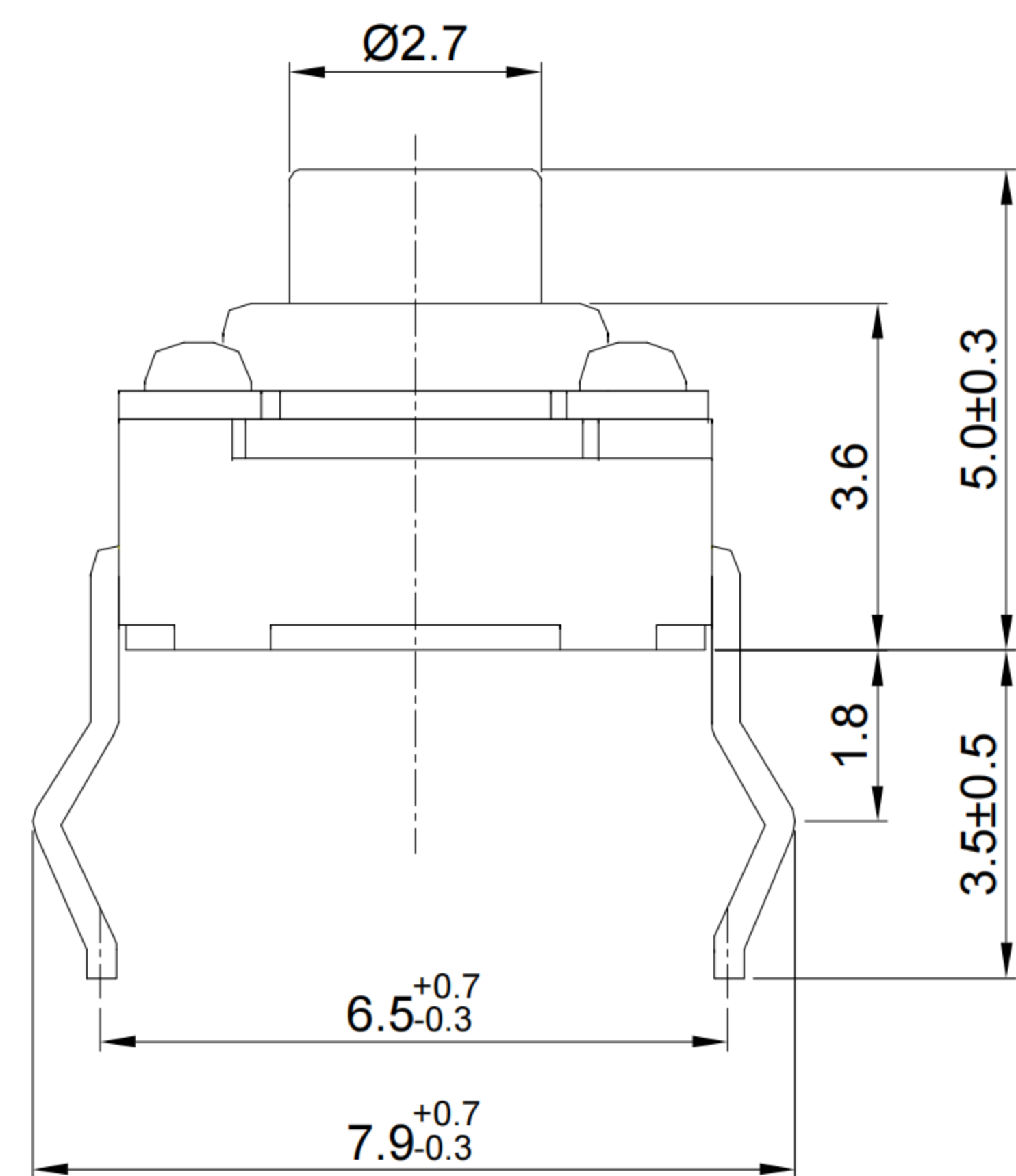

RECOMMENDED PCB LAYOUT

### G-Switch Specification:

1. Operating temperature range: -40°C ~ +85°C
2. Rating: 50mA.12V DC
3. Insulation resistance: 100MΩ min.100V DC
4. Dielectric strength: 250V AC for 1 min
5. Contact resistance:100m Ω max.
6. Travel: 0.30±0.1mm
7. Waterproof grade: IPX7

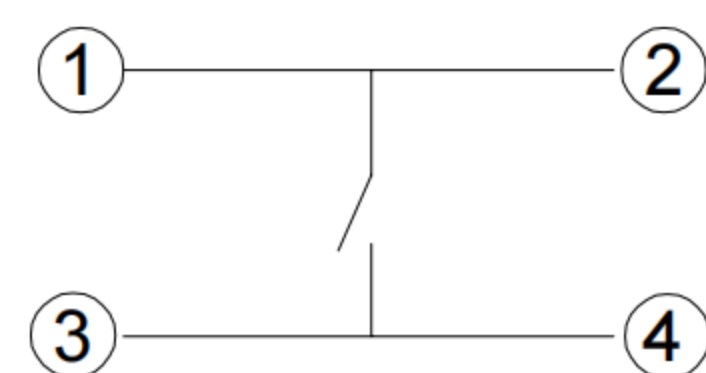

CIRCUIT DIAGRAM

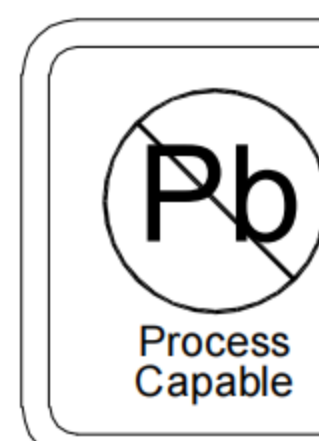

**RoHS**  
Compliant  
EU RoHS Standards



SCALE: 1:1 UNIT: mm  
SIZE: A4

Unless otherwise  
General Tolerance:  
X. ±0.30  
X.x ±0.20  
X.xx ±0.15  
X.xxx ±0.10  
Angles ±3°

Title: Vertical Tact Switch IPX7  
SMT 6.2×6.2×5.0mm

Molde Code: GT-TC121X-HXXX-LX

DRAWN	CHECKED	APPROVED	DATE
Xia	Chen	Chen	2023.02.01



REV: A0 SHEET: 1/1