

GT-TC047X-H016-L1A

Attach characteristics
A=Base With Pilot
N=Non Pilot

G-SWITCH Operating Force

A=180gf
B=250gf
C=220gf

Switch Height (mm)
H=016 (1.6mm)

Switch lifetime (Force)
L1=100,000 Cycles

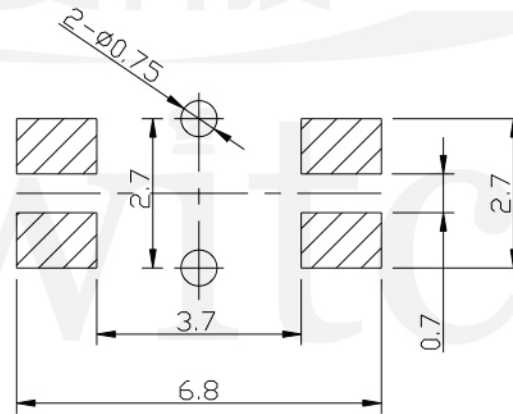
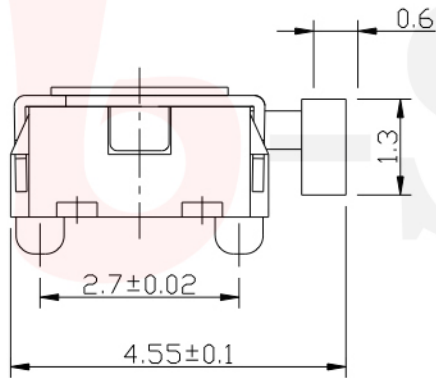

P.C.B LAND DIMENSION

G-Switch Specification:

Operating temperature range: -30°C to +85°C
Rating: 50mA, 12V DC
Insulation resistance: 100MΩ min. 100V DC
Dielectric strength: 250V AC for 1 min
Contact resistance: 100mΩ max.
Travel: 0.2±0.05mm

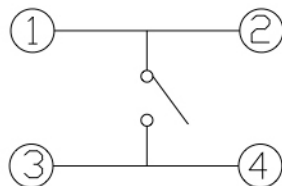

CIRCUIT DIAGRAM



G-Switch Electronic (HongKong) CO.,Ltd.

Unless otherwise specified, Tolerance:
X. ±0.30
X.x ±0.20
X.xx ±0.15
X.xxx ±0.10
Angles ±3°

DESIGN	陈锋枫	DATE	2016.05.29
CHECKED		DATE	
APPROVED		DATE	
http://www.dg-switch.com			
TEL: 0769-82388879			

Molde code:		
GT-TC047X-H016-L1A		
REV.: X1	SCALE: 4:1	UNIT: mm
SIZE: A4	SHEET: 1/1	

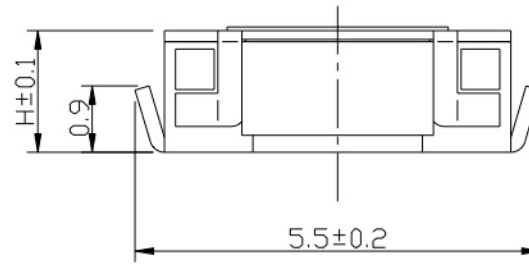
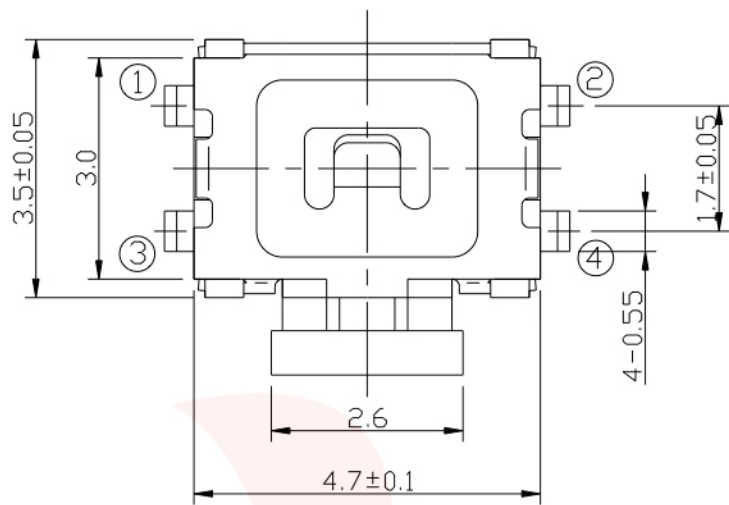

GT-TC047X-H016-L1N

G-SWITCH Operating Force

A=180gf
B=250gf
C=220gf

Switch Height (mm)
H=016 (1.6mm)

Switch lifetime (Force)
L1=100,000 Cycles

Attach characteristics
A=Base With Pilot
N=Non Pilot

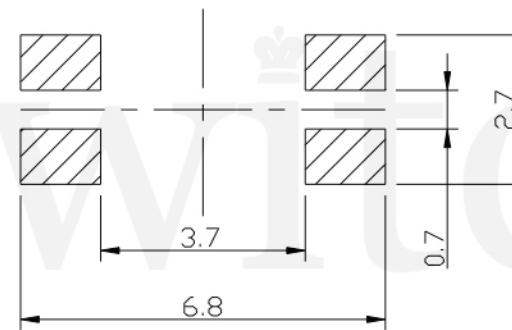
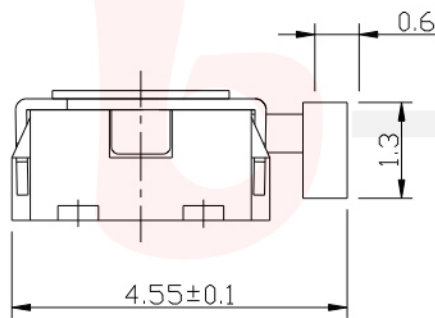

P.C.B LAND DIMENSION

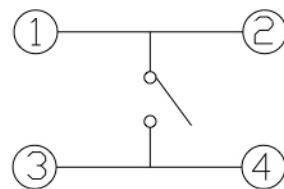

CIRCUIT DIAGRAM



G-Switch Electronic (HongKong) CO.,Ltd.

Unless otherwise specified, Tolerance:
X. ±0.30
X.x ±0.20
X.xx ±0.15
X.xxx ±0.10
Angles ±3°

DESIGN	陈锋枫	DATE	2016.05.29
CHECKED		DATE	
APPROVED		DATE	
http://www.dg-switch.com			
TEL: 0769-82388879			

Molde code:		
GT-TC047X-H016-L1N		
REV.: X1	SCALE: 4:1	UNIT: mm
SIZE: A4	SHEET: 1/1	

G-Switch Specification:

Operating temperature range: -30°C to +85°C

Rating: 50mA, 12V DC

Insulation resistance: 100MΩ min, 100V DC

Dielectric strength: 250V AC for 1 min

Contact resistance: 100mΩ max.

Travel: 0.2±0.05mm